

## **TABLE OF CONTENTS**

### **SECTION 1:**

FUNCTION AND SPECIFICATIONS	1
UNPACKING AND SETUP	2

### **SECTION 2:**

#### **ILLUSTRATIONS & PARTS LIST**

<b>FIGURE 1</b>	BASE	3
<b>FIGURE 2</b>	WATER RESERVOIR, TUBING, “T” VALVES	4
<b>FIGURE 3</b>	CURING STATION	5
<b>FIGURE 4</b>	SAFETY COVER	6
<b>FIGURE 5</b>	2 <sup>ND</sup> BUCKLE CHUTE	7
<b>FIGURE 6</b>	CURING COVER, MOTOR CONTROL, CONTROL PANEL	8
<b>FIGURE 7</b>	MOTOR, GEARS, BRACKETS, PLATES, DRIVE CHAIN	9
<b>FIGURE 8</b>	DRIVE GEARS, CHAIN, WATER WICK, BRACKETS	10
<b>FIGURE 9</b>	SIDE FRAMES, FOOT, ELECTRICAL	11
<b>FIGURE 10</b>	F312 SHEET FEEDER	12
<b>FIGURE 11</b>	F312 SHEET FEEDER CONTINUED	13

## **Function:**

The INFOSEAL model 2612 is one-step self-contained tabletop folder/sealer for self-mailer forms. It accepts either sheet-fed or web-fed (continuous) forms treated with water-activated glue, moistens them, folds them in a buckle-chute folder, and seals them. It is not for use with heat-sealed forms. For unglued forms, you can retract the water system and use the 2612 as a non-sealing folder.

## **Specifications:**

<b>Electrical</b>	120 Vac, 60 Hz: 205 Amp.
<b>Water</b>	2 gallons
<b>Dimension: Footprint:</b>	40" wide x 21" deep
<b>Width</b>	26 ½" alone 40" with stacker tray 43 ½" with sheet feeder 59" with sheet feeder and stacker tray
<b>Depth</b>	21"
<b>Height</b>	21 ½" alone 25 ½" with sheet feeder.
<b>Weight</b>	135 lbs. Shipped wt; 110 lbs. Installed
<b>Floor Space:</b>	36 ½" x 19" (30" high table recommended)
<b>Forms: Size</b>	8 ½" wide, 7" to 17" long (sheet feeder) 9 ½" wide (before trim), 7" to 17" long (2614 burster)
<b>Weight</b>	20 lb. Minimum to 28 lb. Maximum

## **Unpacking:**

- 1 Check package for shipping damage. If there is shipping damage do not discard the box.
- 2 CAUTION: Two people must lift the machine out of the box.
- 3 Unpack the sheet feeder and install it onto the 2612.
- 4 Plug cord into wall outlet.

## **Setup:**

### **Water Tank:**

The water tank fill port is located under output stacker. Be sure to fill the water tank before turning machine on. Fill the water tank to 1" below the top of the tank, and add one tablespoon of bleach to the tank. Be sure to reinstall the rubber cap after filling the water tank. NOTE: Adding bleach to the water tank is recommended once per month.

**Caution: Never run the machine without water!**

### **2613 Sheet Feeder**

The 2613 sheet feeder is attached to the left end of the unit and latches into place. To install set the two lower notches in the underside of the sheet feeder on the lower pins of the folder. Then raise the left end of the feeder, rotating it onto the pins, until the upper pair of notches drop onto the upper pins. Lower the feeder so it rests on all pins. Press down firmly on the feeder until feeder snaps solidly into place.

### **2620 Power Feeder**

For installation of the 2620 feeder refer to the 2620 manual.

### **Replacing the wicks**

Over time the wicks become worn and must be replaced. Remove the thumbscrews from each reservoir lid and remove the wicks. Replace the wicks with the adjuster tab facing up and the tapered end (tail) of the wick in the water. This should be done as often as needed or once per year.

### **Left Buckle Chute**

The left buckle chute lifts up and out to easily adjust fold settings. Set the left buckle chute by adjusting the height of each buckle stop. The stops should be set to the same mark on each side, so the folds will be straight and parallel. Adjust buckle chute according to the setting decal on right buckle chute.

### **Right Buckle Chute**

Adjust both stops to the same mark for the form to fold evenly. Adjust the buckle chutes according to the setting decal on the right buckle chute.

### **Stacker Wheels**

The stacker wheels must be adjusted according to the length of the form. Proper shingling requires the wheels to be positioned further out toward the exit end of the folder when running longer forms. Shorter forms must shingle under the wheels sooner which requires the wheels to be positioned closer to the buckle chutes.

**NOTE: The hotter the printer the more curl in the paper. However lowering the temperature may void warranty, and may cause toner not to bond to paper. There for it is not recommended to lower the temperature on the printer settings.**

Fig. 1 Base

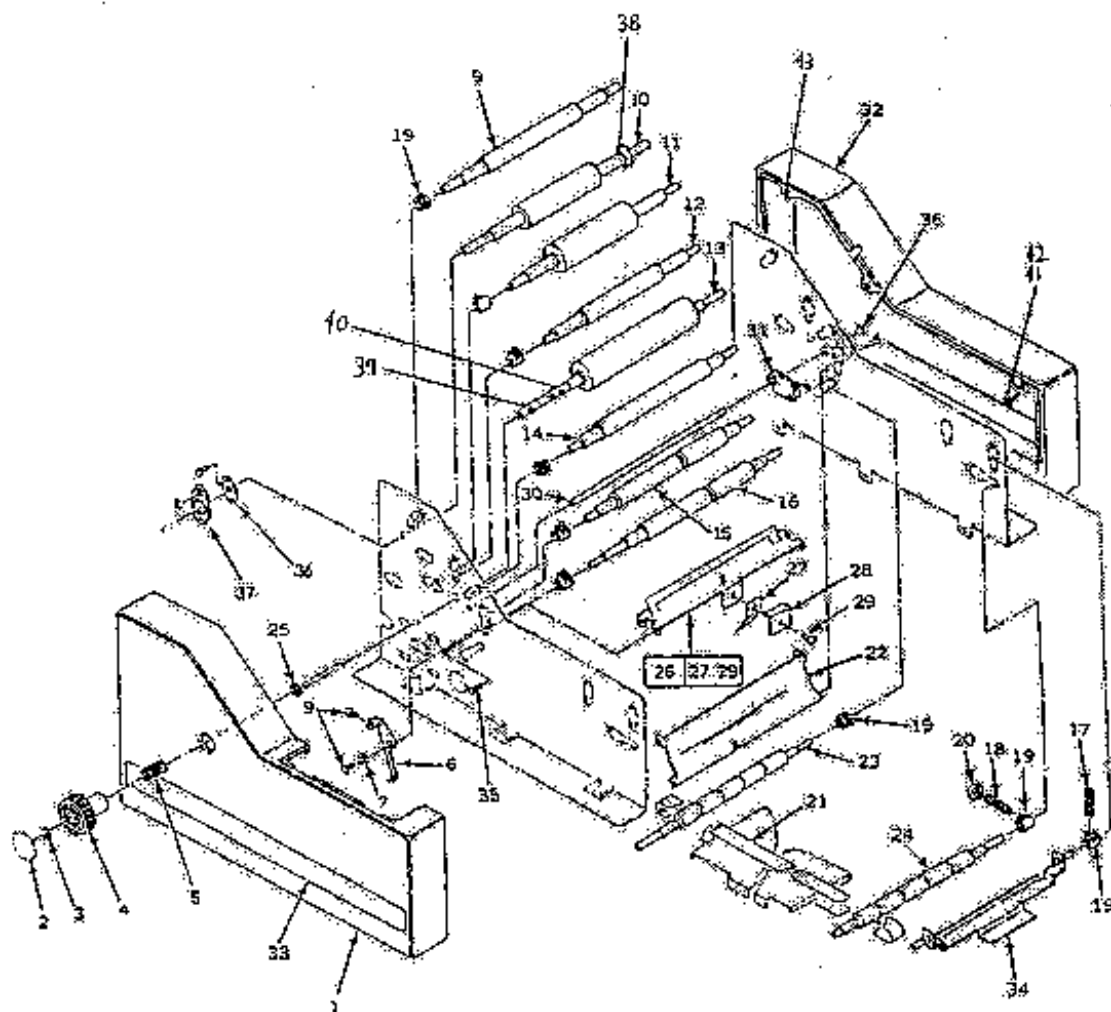

## PARTS LISTING

### FIG. 1- BASE

ITEM PARTS #	DESCRIPTION	QTY	
1	F362000	COVER-LEFT (DRIVE SIDE)	1
2	360-1232	CAP, PAINTED #381-0083 VELCRO PAD	1
3	379-0023	CLIP-RETAINER – EXTERNAL 3/8” SPINDLE 10MM	1
4	320-0048	CRANK/HANDWHEEL KNOB ASSEMBLY	1
5	1820509	SPRING – COMPRESSION- KNOB	1
6	F351046	BRACKET – SWITCH TIMING	1
7	377-0042	FLAT WASHER .255 X .566 X .048	1
8	373-0094	SCREW 6-32 X .50 W/EXT STAR	2
9	F380004	INPUT ROLLER AND SHAFT ASSEMBLY 1”	1
10	F380011	INPUT ROLLER AND SHAFT ASSEMBLY 1.5”	1
11	F380009	DRIVER ROLLER ASSEMBLY 2”	1
12	F380005	ROLLER AND SHAFT ASSEMBLY – 1 <sup>ST</sup> FOLD	1
13	F380010	MAIN DRIVER ROLLER AND SHAFT ASSEMBLY	1
14	F380006	ROLLER AND SHAFT ASSEMBLY – 2 <sup>ND</sup> FOLD	1
15	F380007	ROLLER AND SHAFT ASSEMBLY – UPPER IRONING	1
16	F380008	SHAFT ROLLER ASSEMBLY – LOWER IRONING	1
17	F320001	SPRING - COMPRESSION	12
18	F384011	SPRING - COMPRESSION	2
19	F362007	BEARING – FRAME 2216	20
20	F362043	SUPPORT SPRING	2
21	F365001	BELT – CURING STATION - BOTTOM	5
22	F380068	IRONING DECK ASSEMBLY	1
23	F313001	ROLLER – DRIVE OUTPUT	1
24	F313000	ROLLER - OUTPUT	1
25	5450237	SHIM OSCILLATOR WASHER-HANDWHEEL KNOB	1
26	F380075	MYLAR KICKER ASSEMBLY 2612	1
27	F362023	STRIP – KICK DOWN	1
28	F351049	CLAMP – MYLAR KICKER	1
29	373-0088	SCREW 8-32 X ¼” PSPN	1
30	F310020	SHAFT – SWITCH TIMING	1
31	311-0044	COUNTER SWITCH 17” – TIMING SHAFT	1
32	F362001	COVER – RIGHT (OPERATOR SIDE)	1
33	325-0259	DECAL, DOCUSEAL 2612, #326-0091 LABEL, 2612	2
34	F380062	CURING STATION LOCK BRACKET ASSEMBLY	1
35	373-0095	SCREW 8 – 32 C .375 PSPN	4
36	F384014	BEARING, FLANGED	2
37	F380080	TENSIONER, ASSEMBLY	2
38	F332000	SHEET FEEDER DRIVE GEAR 20T	
39	381-2845	PIN/HANDWHEEL, 1/8 DIA. SPRING PIN	
40	381-0018	SPRING PIN/PULLEY 1/8 X 1	
41	373-0016	COVER SCREW 10-32 X ½ LG	
42	377-2809	STAR WASHER FOR COVER SCREW #10	
43	381-0011	COVER CLIP	
44	390-0290	3324 INTERFACE ASSY (NOT SHOWN)	

**Fig. 2-Water Reservoir, Tubing, "T" Valves**

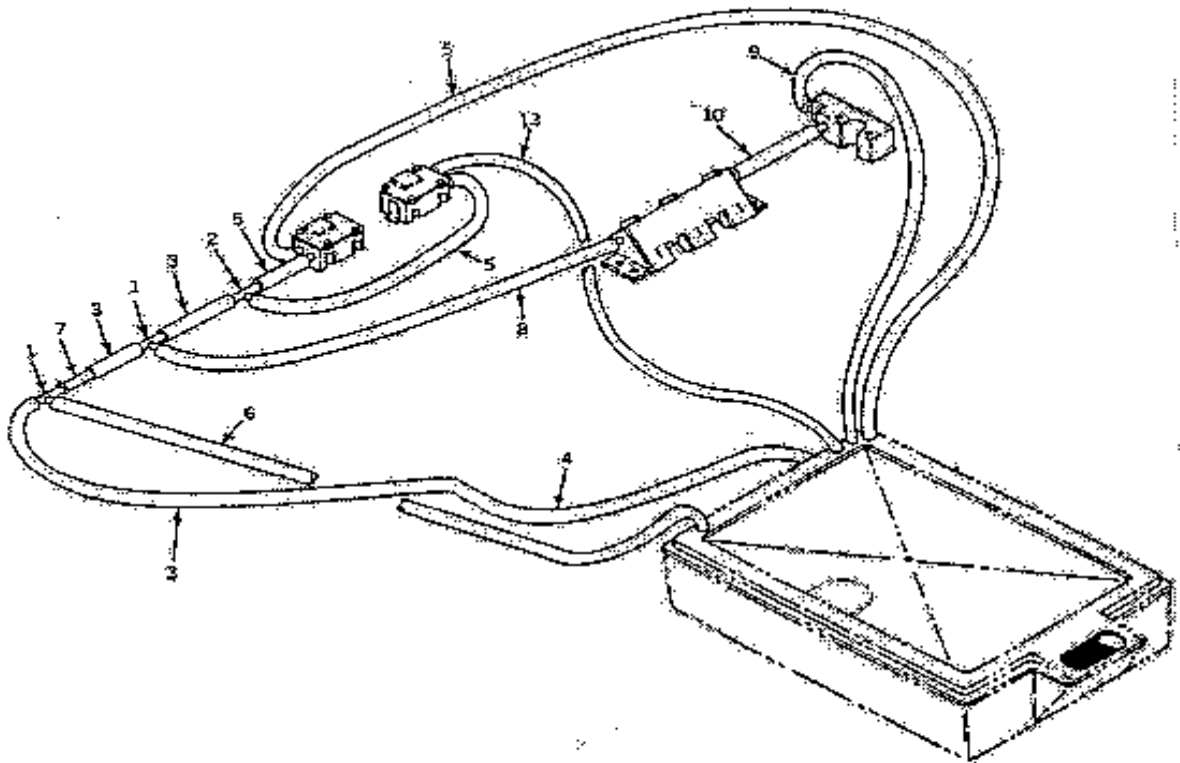

## PARTS LISTING

### FIG. 2 – WATER RESERVOIR, TUBING, “T” VALUES

<u>ITEM PART #</u>	<u>DESCRIPTION</u>	<u>QTY</u>
1 F362041	VALVE - “T” FITTING	2
2 F362019	VALVE – “ T” FITTING	1
3 F362034	TUBING- PVC VALVE	4
4 F362033	TUBING- PVC	1
5 F362032	TUBING- WICK – LEFT & RIGHT 3/8”	2
6 F362047	TUBING- WATER RESERVOIR	1
7 F362046	RESTRICTOR	1
8 F362048	TUBING - PVC	1
9 F362040	TUBING - ¼”	1
10 F362030	TUBING - PVC	1
13 F 362031	TUBING - PVC	2

**Fig. 3-Curing Station**

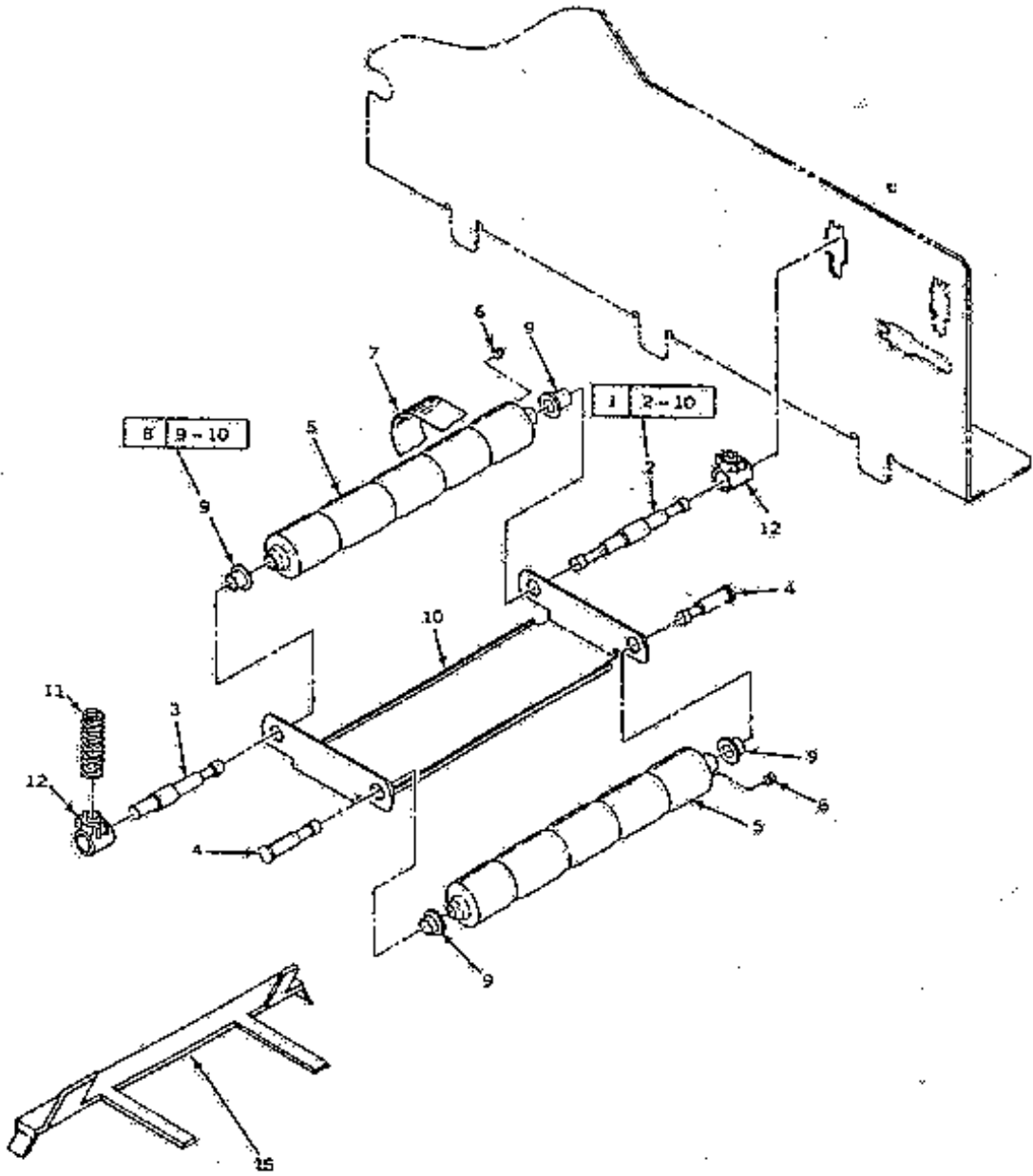

## PARTS LISTING

### FIG. 3 – CURING STATION

<b>ITEM</b>	<b>PART #</b>	<b>DESCRIPTION</b>	<b>QTY</b>
1	F380030	CURING STATION ASSEMBLY - COMPLETE	1
2	F310010	CURING STATION DRIVE SHAFT ASSEMBLY	1
3	F310011	CURING STATION ENTRY IN SHAFT ASSEMBLY	1
4	F310012	SHAFT – EXIT – CURING STATION	2
5	F313003	ROLLER – CURING STATION	2
6	376-6559	10-32 X ½ KNURLED CUP POINT SET SCREWS	4
7	F365000	BELT – CURING STATION - TOP	4
8	F380061	CURING STATION BRACKET ASSEMBLY	1
9	175-0144	BEARING, FLANGED	4
10	F351035	BRACKET – CURING STATION	1
11	F323003	SPRING – ROLLER STACK	2
12	F362007	BEARING FRAME 2216	2
13	F362052	ACETATE STACKER	1
14	F310021	SHAFT – SAFETY COVER	2
15	F351066	LONG FORM ACCESSORY	1

Fig. 4- Safety Cover

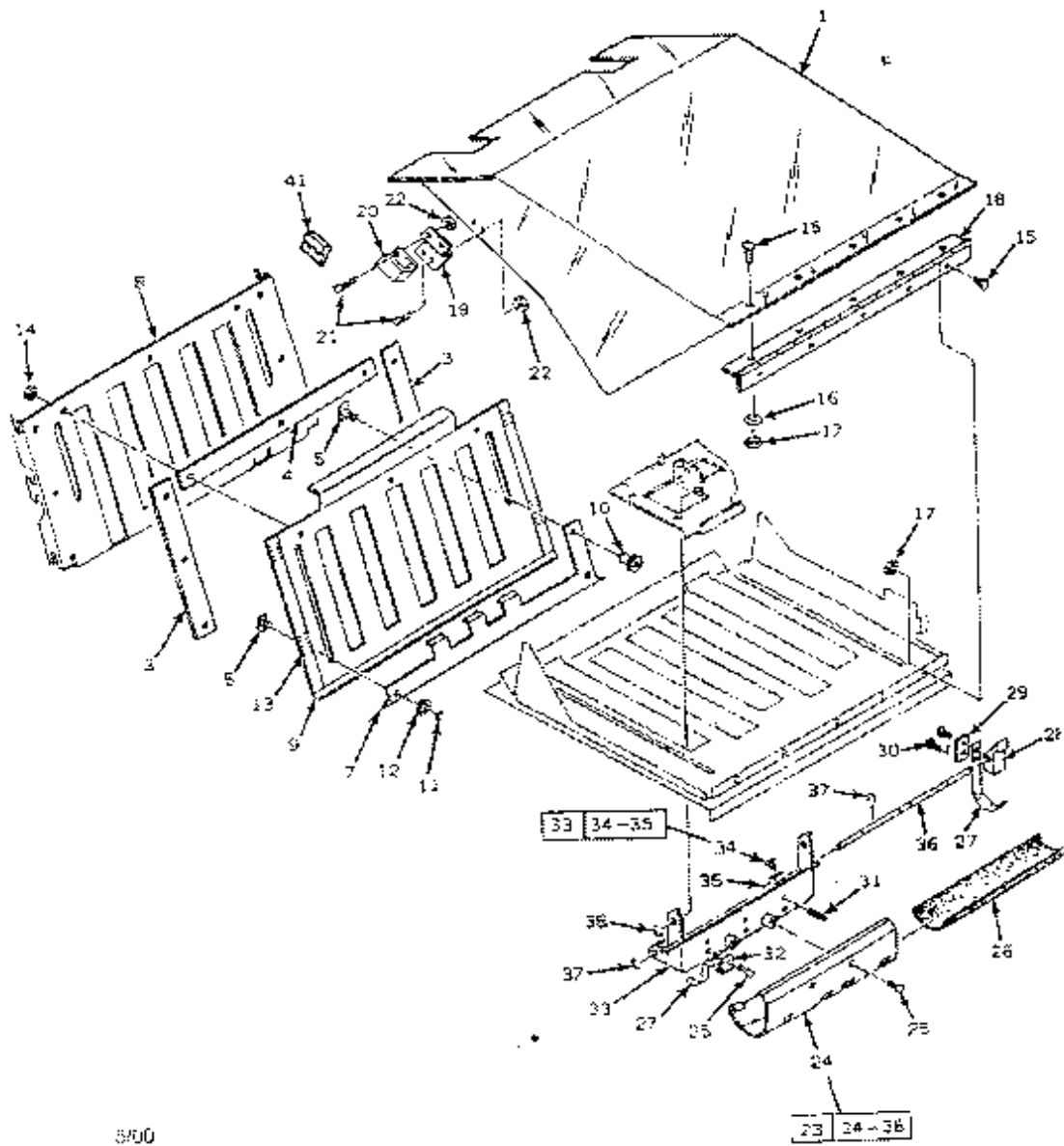

300

## PARTS LISTING

### FIG. 4 – SAFETY COVER

<u>ITEM</u>	<u>PART #</u>	<u>DESCRIPTION</u>	<u>QTY</u>
1	F362044	COVER – SAFETY	1
2	F380015	FIRST BUCKLE CHUTE ASSEMBLY	1
3	F350001	SPACER PLATE SIDE	2
4	F350002	SPACER PLATE TOP	1
5	F311003	STUD PLATE	1
7	F351007	STOP 1 <sup>ST</sup> BUCKLE CHUTE	1
8	F351009	FRAME 1 <sup>ST</sup> BUCKLE CHUTE	1
9	F380017	1 <sup>ST</sup> BUCKLE CHUTE GUIDE ASSEMBLY	1
10	1416119	NUT KNURLED	2
11	25-0018	CLIP RETAINER BOWED	1
12	375014	WASHER PLATE STUD	1
13	3165503	SCALE BUCKLE CHUTE	2
14	80-0072	NUT SELF TAPPING	9
15	73-0501	SCREW 6 – 32 X 5/16” – PPN	10
16	50-0007	WASHER PLAIN - .056” X .375” X .051	10
17	71-0003	NUT 6 – 32 X 5/16” – LW	10
18	F384012	SAFETY COVER HINGE ASSEMBLY	1
19	F351063	BRACKET SAFETY COVER	1
20	200-0701	ACTUATOR	4
21	72-0283	SCREW 8 – 32 X 3/8” PSPN	4
22	71-0001	NUT 4 – 40 X 1/4” – LW	4
23	F380028	2 <sup>ND</sup> BUCKLE CHUTE ASSEMBLY COMPLETE	1
24	F351012	SHIELD HAMMESS	1
25	72-0611	SCREW 8 – 32 X 3/8” PSPN	5
26	F367001	ABSORBER FELT	1
27	F365002	GATE – HAMMER	3
28	F362011	HAMMER – GATE	3
29	F362012	DEFLECTOR – HAMMER GATE	3
30	60-8162	SCREW	3
31	F370000	SCREW – HAMMER ADJUSTING	3
32	F351053	CLAMP GATE	3
33	F380031	HAMMERS BRACKET ASSEMBLY	1
34	F362018	STOP NYLON	2
35	15-0504	FASTENER PUSH-ON	2
36	F310006	SHAFT HAMMERS BRACKET	1
37	23-0025	CLIP RETAINER – 1/4” SPINDLE	12
38	25-0018	CLIP RETAINER BOWED	2
41	200-0900	MAGNETIC PROX. SENSOR	1

# Fig. 5-2nd Buckle Chute

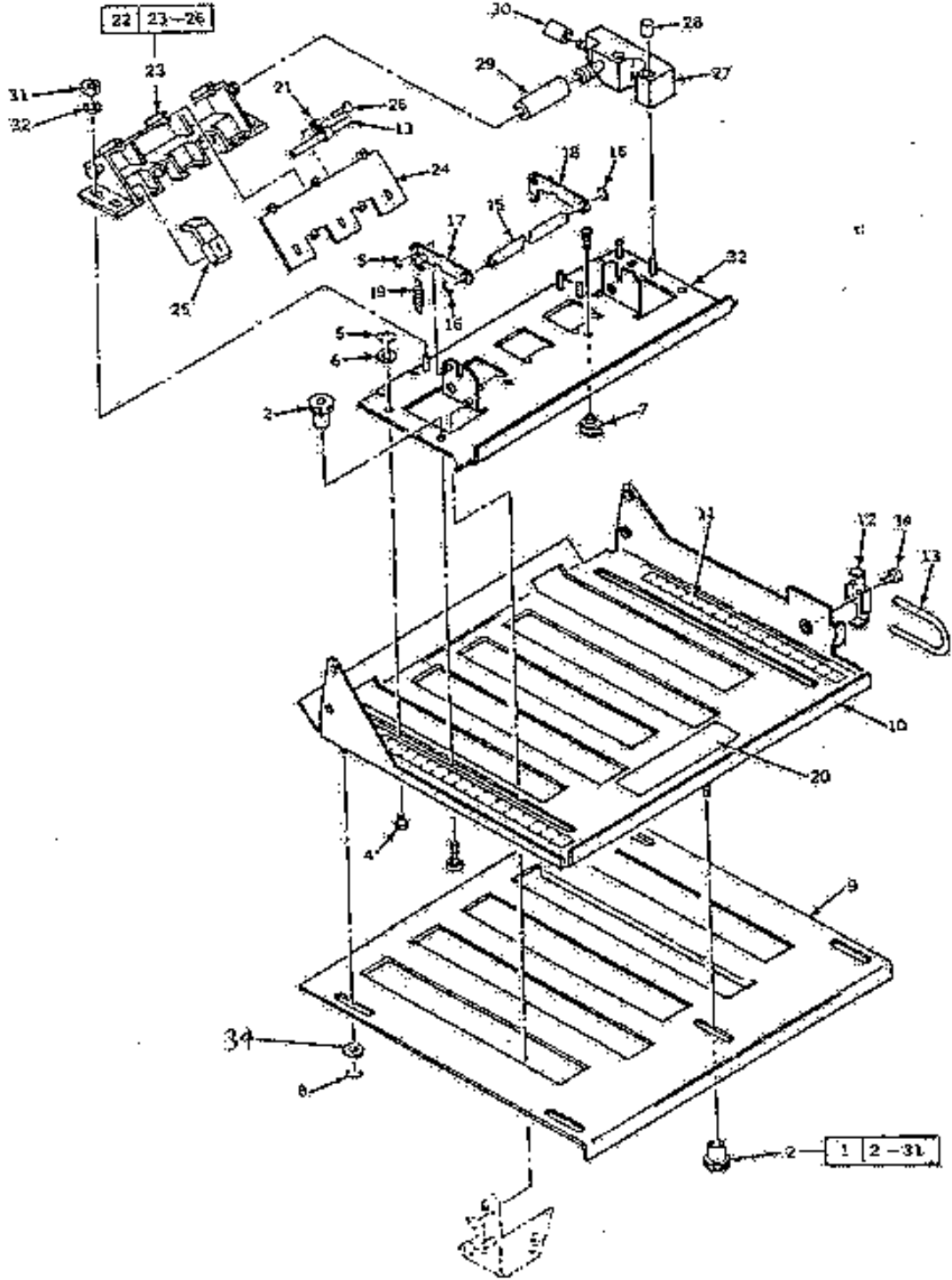

## PARTS LISTING

### FIG. 5 – 2<sup>ND</sup> BUCKLE CHUTE

<u>ITEM</u>	<u>PART #</u>	<u>DESCRIPTION</u>	<u>QTY</u>
1	F380028	2 <sup>ND</sup> BUCKLE CHUTE ASSEMBLY - COMPLETE	1
2	1416119	NUT – KNURLED KNOB OD	3
4	F311003	STUD – PLATE	4
5	379-0024	“E” RING CLIP – RETAINER – BOWED/SHAFT 0.188	4
6	375014	WASHER – PLATE STUD	2
7	F318001	SPACER – SECOND BUCKLE CHUTE	2
8	379-0028	“E” RING CLIP – BOWED/SHAFT 0.250	4
9	F351017	GUIDE – 2 <sup>ND</sup> BUCKLE CHUTE	
10	F380035	FRONT 2 <sup>ND</sup> BUCKLE CHUTE ASSEMBLY	1
11	3165503	DECAL – BUCKLE CHUTE	2
12	F351054	CLAMP – TUBING	1
13	F362048	TUBING – PVC	1
14	78-0835	SCREW – 10-32 X 5/8” – PFUC	1
15	F310005	SHAFT – LATCH	1
16	379-0079	“E” RING BOWED CLIP HD, 0.18	2
17	F380033	LATCH ASSEMBLY – RIGHT HAND	1
18	F380034	LATCH ASSEMBLY – LEFT HAND	1
19	F320000	SPRING – TENSION	2
20	F361010	LABEL – BUCKLE CHUTE SETTING	2
21	315-0039	CLAMP WIRE 0.312 – TUBING	2
22	F380013	WICK TANK ASSEMBLY – COMPLETE	1
23	F380012	FLAP TANK ASSEMBLY	1
24	F362016	COVER – WICK TANK	1
25	F380018	WICK CARTRIDGE COMPLETE/COTTON ALONE F367000	3
26	375-0093	THUMB SCREW 8-32 X 7/16” – PPN	3
27	F380087	WATER RETURN BLOCK ASSEMBLY	1
28	378-0116	NUT W/HEXAGON SOCKET 10-32 WATER RETURN BLOCK	2
29	F362030	TUBING – PVC	1
30	F362040	TUBING – PVC ¼”	1
31	378-0004	#10 KEP NUT (10-32)	1
32	F380032	PLATE	
33	F311011	STUD CLAMP – BUCKLE CHUTE	
34	377-0042	WASHER, FLAT .255 X .566 X .048	
35	F362027	HOSE NIPPLE – FITTING DRAIN ¼”	

**Fig. 6-Curing Cover, Motor Control, Control Panel**

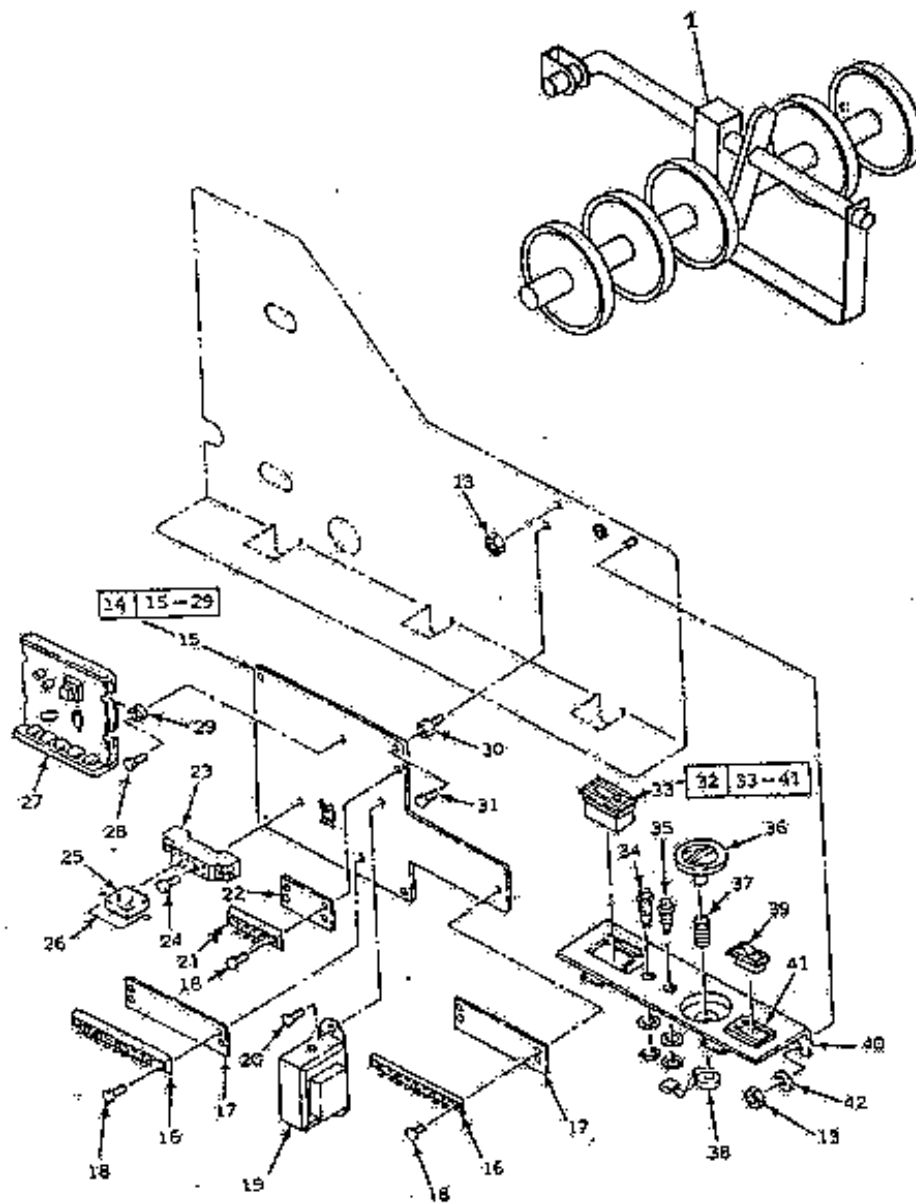

## PARTS LISTING

### FIG. 6 – CURING COVER, MOTOR CONTROL, CONTROL PANEL

<u>ITEM</u>	<u>PART #</u>	<u>DESCRIPTION</u>	<u>QTY</u>
1	395-0729	2625 URGE ROLLER KIT FOR 2612	1
2	320-8135	STACKER WHEEL	5
3	360-1699	SKI ASSEMBLY	1
4	373-0092	SCREW – 4-40 X ½” – PSPN	4
5	378-0111	NUT – 4-40 X ¼” – LW	4
13	378-0110	NUT – 10-32 X 3/8” – LW	8
14	F380090	CONTROL ASSEMBLY – COMPLETE	1
15	F380089	CONTROL PLATE ASSEMBLY	1
16	314-0090	BLOCK – TERMINAL 1-ROW, 10-POS.	2
17	325-0247	MARKING STRIP – TERMINAL 10-POS.	2
18	373-0090	SCREW 6-32 X 5/8” – PSPN	6
19	390-0666	TRANSFORMER ASSEMBLY	1
20	373-0088	SCREW 8-32 X ¼” – PSPN	2
21	314-0009	TERMINAL – STRIP – 4 PIN – SINGLE ROW	1
22	325-0248	STRIP – TERMINAL , 4-POS	1
23	F384008	SOCKET – RELAY MOUNTING	1
24	373-0089	SCREW 4-40 X 7/8” – PSPN	1
25	F384007	RELAY ASSEMBLY	1
26	F384009	CLIP – RELAY MOUNTING	1
27	F384005	DC MOTOR CONTROL ASSEMBLY	1
28	373-0010	SCREW 4-40 X ½” – PSPN	4
29	350-0067	GROMMET .150 ID – RUBBER	4
30	381-0081	STANDOFF – CONTROL GAS SPRING 17”	4
31	373-0095	SCREW 8-32 X 3/8” – PSPN	4
32	F380022	CONTROL PANEL ASSEMBLY	1
33	390-0662	CONTROL PANEL COUNTER ASSEMBLY	1
34	319-0155	INDICATOR – BLUE ASSEMBLY	1
35	319-0156	INDICATOR – RED ASSEMBLY	1
35A	319-0157	LAMP, 24V. .037A	1
36	F362003	KNOB – SPEED CONTROL	1
37	F323003	“D” SPRING/SPEED KNOB	1
38	F384013	SPEED CONTROL POT ASSEMBLY 5K, 75W	1
39	311-0094	ON-OFF SWITCH – ROCKER	1
40	F362002	PANEL – CONTROL	1
41	F362050	GUARD – SWITCH	1
42	377-0042	WASHER – PLAIN .255 X .566 X .048	2
43	F361033	TERMINAL BLOCK COVER	1
44	F3462550	DECAL ELECTRICAL HAZARD	

**Fig. 7-Motor, Gears, Brackets, Plates, Dr. Chain**

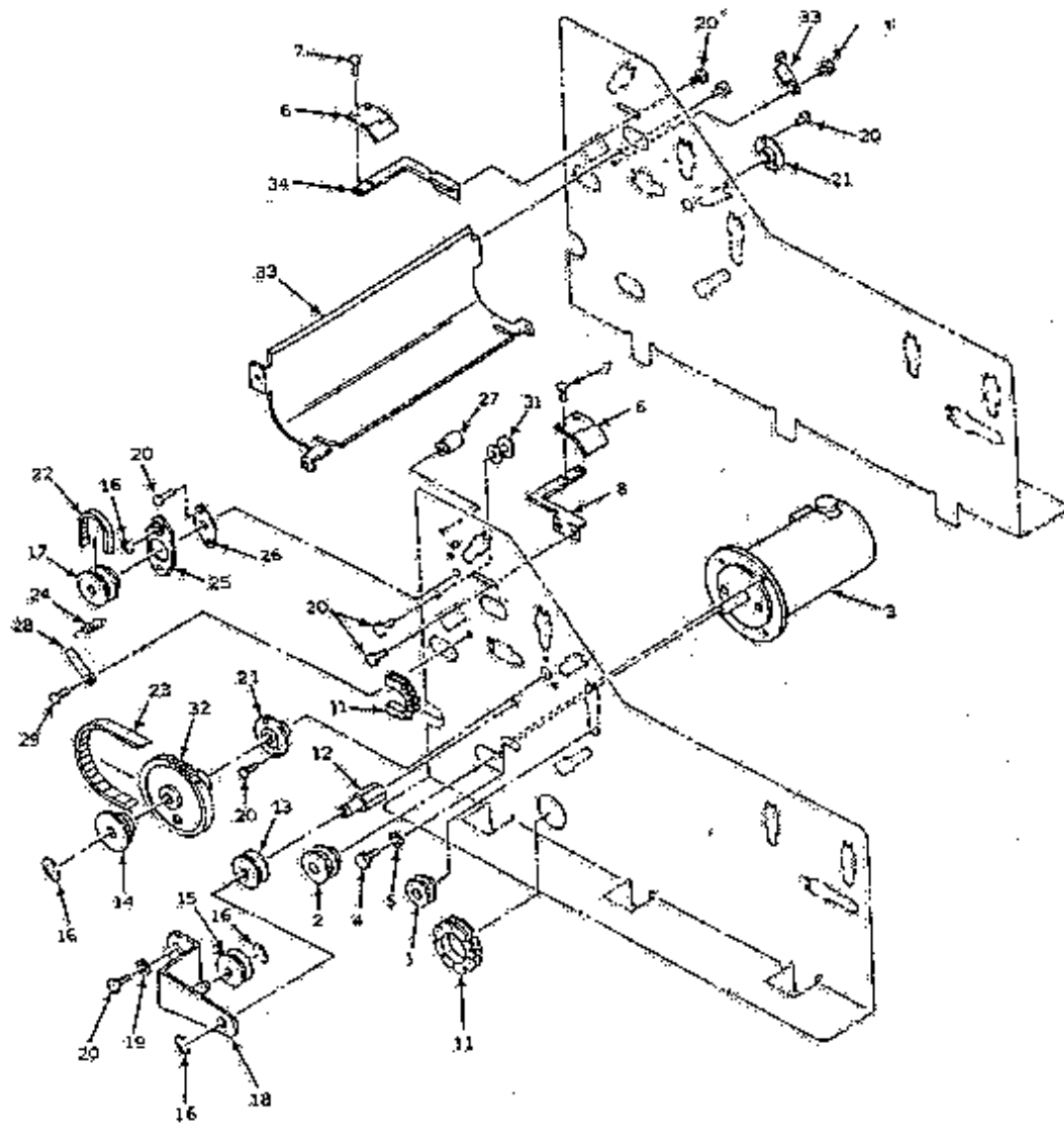

3/00

## PARTS LISTING

### FIG. 7 – MOTOR, GEARS, BRACKETS, PLATES, DR. CHAIN

<u>ITEM</u>	<u>PART #</u>	<u>DESCRIPTION</u>	<u>QTY</u>
1	F337002	PULLEY – 14 GRV – 1/5P DRIVE	1
2	F337005	PULLEY – 19 GRV – 1/5P DRIVE	1
3	390-0665	MAIN DRIVE MOTOR ASSEMBLY	1
4	375-0096	¼-20 HEX HD SCREW W/ ET STAR	4
5	377-1813	¼” WASHER “W”	4
6	F323001	SPRING G – WICK	1
7	375-0055	SCREW 4 – 40 X ¼” BUTTON HEAD	2
8	F380052	WICK SPRING MOUNTING BRACKET ASS. - RIGHT	1
9	373-0094	SCREW 6-32 X ½” – PPS	2
10	F350008	SPACER – MOTOR	1
11	244-0101	CHANNEL – RUBBER	1
12	F311005	STUD – PIVOT TENSION	1
13	F380020	TENSION ROLLER ASSEMBLY	1
14	F337001	PULLEY – 28 GVR – 1/5P	1
15	F380021	PULLEY ASSEMBLY – 21 GROOVES	1
16	379-0014	CLIP – RETAINER – 3/8” SPINDLE	4
17	F337000	PULLEY – 21 GRV – 1/5P	1
18	F380019	TENSIONER BRACKET ASSEMBLY	1
19	377-0042	WASHER – PLAIN .255 X .566 X .048	2
20	373-0096	SCREW 10-32 X 3/8” – PSPN	2
21	F380029	RETAINER BEARING ASSEMBLY	2
22	365-0137	TIMING BELT 300 X L037 PULLEY, FEED ROLLER DR.	1
23	365-0136	TIMING BELT 210 X L037, MAIN DRIVE	1
24	F320005	SPRING – TENSION	2
25	F380080	TENSIONER ASSEMBLY	2
26	371-0076	BEARING ALIGN 0.37 – FLANGED	2
27	F311020	STUD – FEEDER MOUNTING	2
28	F351055	LEVER – AUTO ADJUSTING – RIGHT	1
29	5611526	SCREW – SHOULDER – 10-32	2
30	F351056	LEVEL – AUTO ADJUSTING – LEFT	1
31	F311016	STUD – PIVOT	2
32	F337004	PULLEY – 60T – 1/5P	1
33	F380047	INPUT GUIDE ASSEMBLY	1
34	F380053	WICK SPRING MOUNTING BRACKET ASS. - LEFT	1

**Fig. 8-Drive Gears, Chain, Water Wick, Bracket**

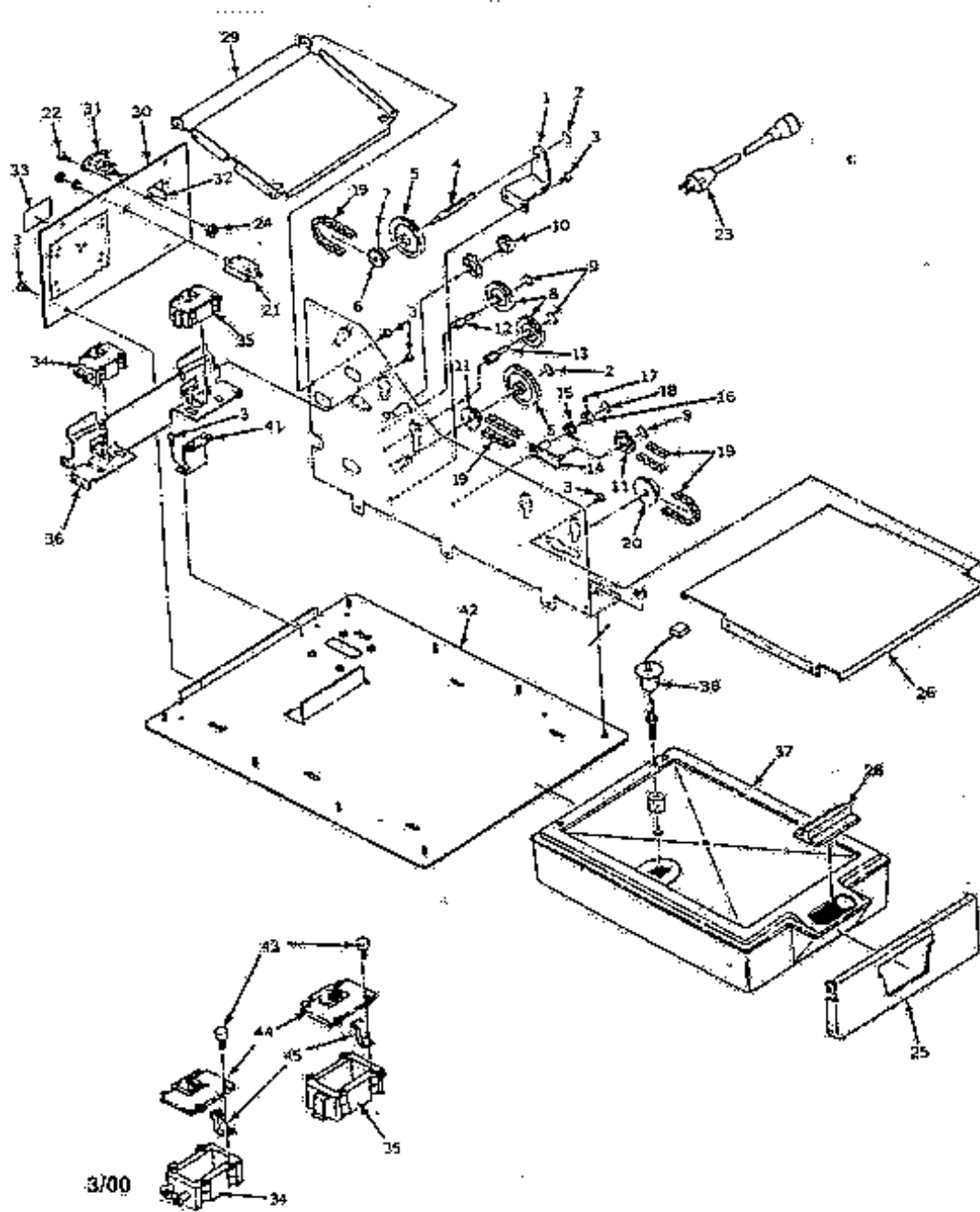

## PARTS LISTING

### FIG. 8 – DRIVE GEARS, CHAIN, WATER WICK, BRACKET

<u>ITEM</u>	<u>PART #</u>	<u>DESCRIPTION</u>	<u>QTY</u>
1	F380045	BRACKET – ROLLER	1
2	23-0031	CLIP – RETAINER – 5/16” SPINDLE	1
3	373-0096	SCREW – 10-32 X 3/8” – PSPN	2
4	F310009	SHAFT – GEAR PULLEY	1
5	F333000	GEAR – 80T	2
6	3131069	SPROCKET – 250P - .3771D (16T)	1
7	376-0078	10-32 X ¼ KNURLED CUP PT SCREW SET	2
8	F333001	GEAR – 28T/64T	2
9	23-0025	CLIP – RETAINER ¼” SPINDLE	3
10	F335000	GEAR – CONVEYOR DRIVE	1
11	F380063	SPROCKET ASSEMBLY – 16T	2
12	F311000	STUD – UPPER GEAR	1
13	F311002	STUD – CENTER GEAR	1
14	F380064	ARM/ STUD ASSEMBLY	1
15	422101	SPRING – TENSION	1
16	F315000	COLLAR – SPRING	1
17	376-0069	8-32 X ¼” SOC. SCREW SET	1
18	379-0014	CLIP – RETAINER – 3/8” SPINDLE	1
19	367-0022	½” PITCH CHAIN LENGTH 32” - DRIVE	1
20	F331001	SPROCKET – 24T	1
21	311-0084	3-AMP CIRCUIT BREAKER ASSEMBLY	1
22	373-0092	SCREW – 4-40 X ½” – PSPN	2
23	310-0039	POWER CORD ASSEMBLY, DETACHABLE	1
24	378-0111	NUT – 4-40 X ¼” – LW	1
25	F380043	TANK COVER ASSEMBLY	1
26	F380044	OUTPUT DECK ASSEMBLY	1
28	F365004	CAP- WATER TANK	1
30	F38000	MOTOR SHIELD ASSEMBLY	1
31	319-0161	RFI FILTER – INPUT COVER	1
32	F383005	2612 MAIN HARNESS ASSEMBLY	1
33	F361001	LABEL – UL/ BUCKLE CHUTE	1
34	F380024	WICK TANK – RIGHT HAND	1
35	F380025	WICK TANK – LEFT HAND	1
36	F380046	ENTRY GUIDE ASSEMBLY – UPPER	1
37	395-0706	2612 WATER TANK RESERVOIR W/ WATER PUMP KIT	1
38	F383008	WATER LEVEL SENSOR ASSEMBLY	1
40	373-0094	SCREW 6-32 X ½” – PSPN	2
41	F380048	PUMP MOUNTING BRACKET ASSEMBLY	1
42	F380054	BASE PLATE ASSEMBLY	1
43	375-0093	8-32 THUMBSCREW	4
44	F362006	COVER, WICK TANK HOUSING	1
45	F380018	WICK CARTRIDGE COMPLETE/ COTTON ALONE F367000	1
46	F384019	WATER BOTTLE	1

**Fig. 9-Side Frames, Foot, Electrical**

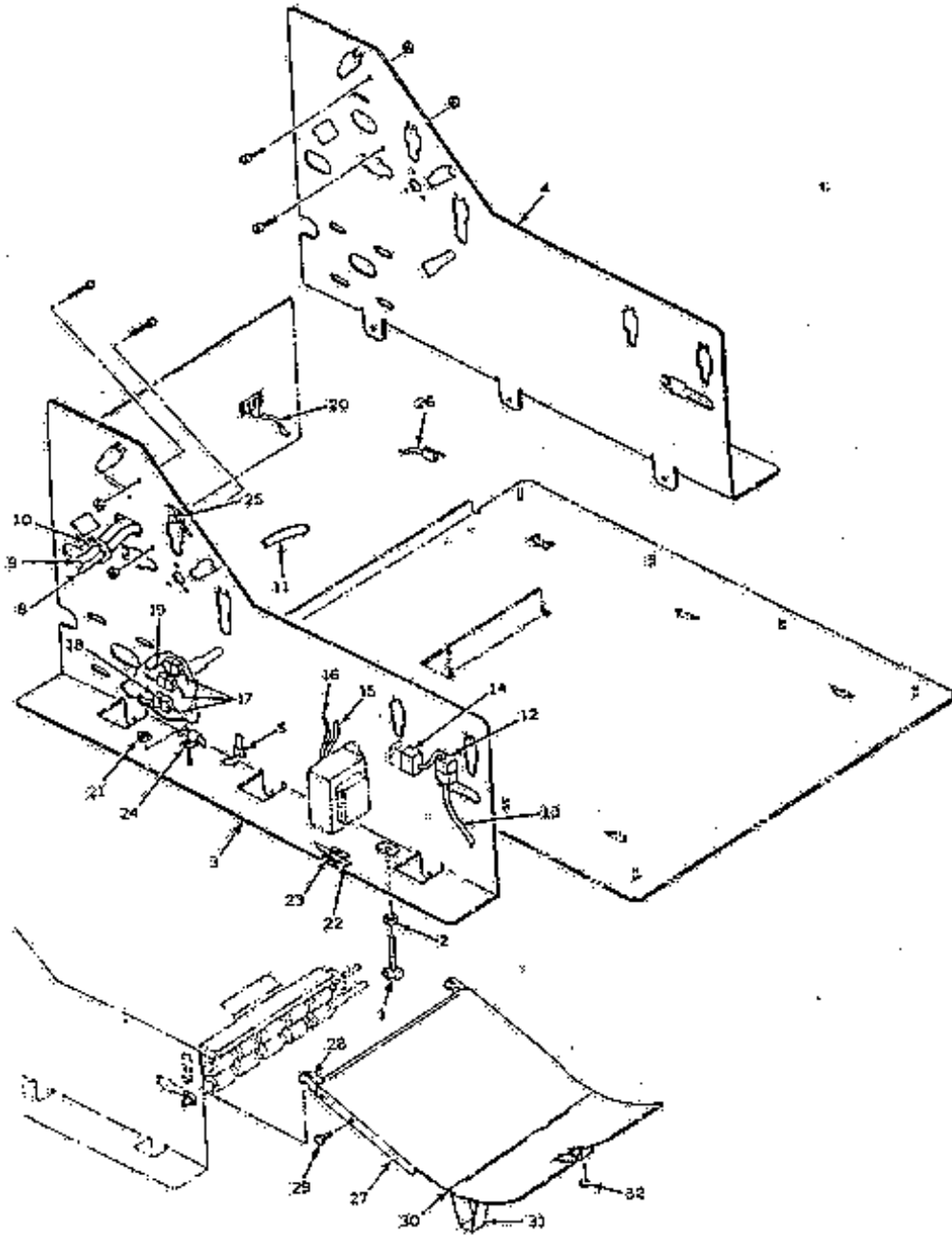

## PARTS LISTING

### FIG. 9 – SIDE FRAMES, FOOT, ELECTRICAL

<u>ITEM</u>	<u>PART #</u>	<u>DESCRIPTION</u>	<u>QTY</u>
1	3385037	BOLT – FOOT, ADJUSTABLE	4
2	378-0011	NUT – 3/8 – 16 X 9/16 – LW	4
3	F380055	SIDE FRAME ASSEMBLY – RIGHT	1
4	F380056	SIDE FRAME ASSEMBLY – LEFT	1
5	314-0089	CLAMP, CABLE	2
6	F351027	COVER – PUMP INLET	1
7	373-0095	SCREW 8-32 X 3/8” - PSPN	4
8	F362032	3/8” TUBING – WICK - LEFT	2
9	F362031	TUBING - PVC	1
10	319-1884	CABLE TIE	12
11	F362033	TUBING - PVC	1
12	F383005	2612 MAIN HARNESS ASSEMBLY	1
13	F383006	CONTROL PANEL HARNESS ASSEMBLY - POWER	1
14	F383009	CONTROL PANEL HARNESS ASSEMBLY	1
15	F383013	RELAY HARNESS ASSEMBLY	1
16	F383011	POWER CONTROL HARNESS ASSEMBLY	1
17	F383001	LOWER VOLTAGE HARNESS ASSEMBLY	1
18	F383008	WATER LEVEL SENSOR ASSEMBLY	1
19	F383012	CONTROL SWITCH HARNESS ASSEMBLY	1
20	F383000	BURSTER HARNESS ASSEMBLY - RECEPTACLE	1
21	227-0017	CLAMP - HARNESS	3
22	315-5853	PANDUIT TIE WRAPS 1.51 MP	1
23	315-5800	MOUNT – CABLE TIE	1
24	378-0013	NUT 8-32 X 11/32” LW	3
25	314-0088	USE #315-0019 CABLE MOUNT	4
26	F383012	CONTROL SWITCH HARNESS ASSEMBLY	1
27	F380001	COLLECTOR ASSEMBLY STACKER	1
28	F362013	BRACKET - COLLECTOR	2
29	373-0086	SCREW – SELF-TAPPING 10-32 X 1/2” FLAT HEAD	4
30	378-0098	10-24 HEX NUT	4
31	F351004	BRACKET – SUPPORT - COLLECTOR	2
32	351-0009	GROMMET – RUBBER BUMPER	2
33	3187613	CONVEYOR COVER HARNESS ASSEMBLY	2
34	373-0092	SCREW 4-40 X 1/2” PSPN	4
35	377-0040	.125 X .312 X .030 WASHER	4
36	378-0111	NUT – 4-40 X 1/4” - LW	4
37	F312003	PIN – BUCKLE PLATE MOUNTING	1
37A	378-0013	NUT	1

Fig. 10- F312 Sheet Feeder

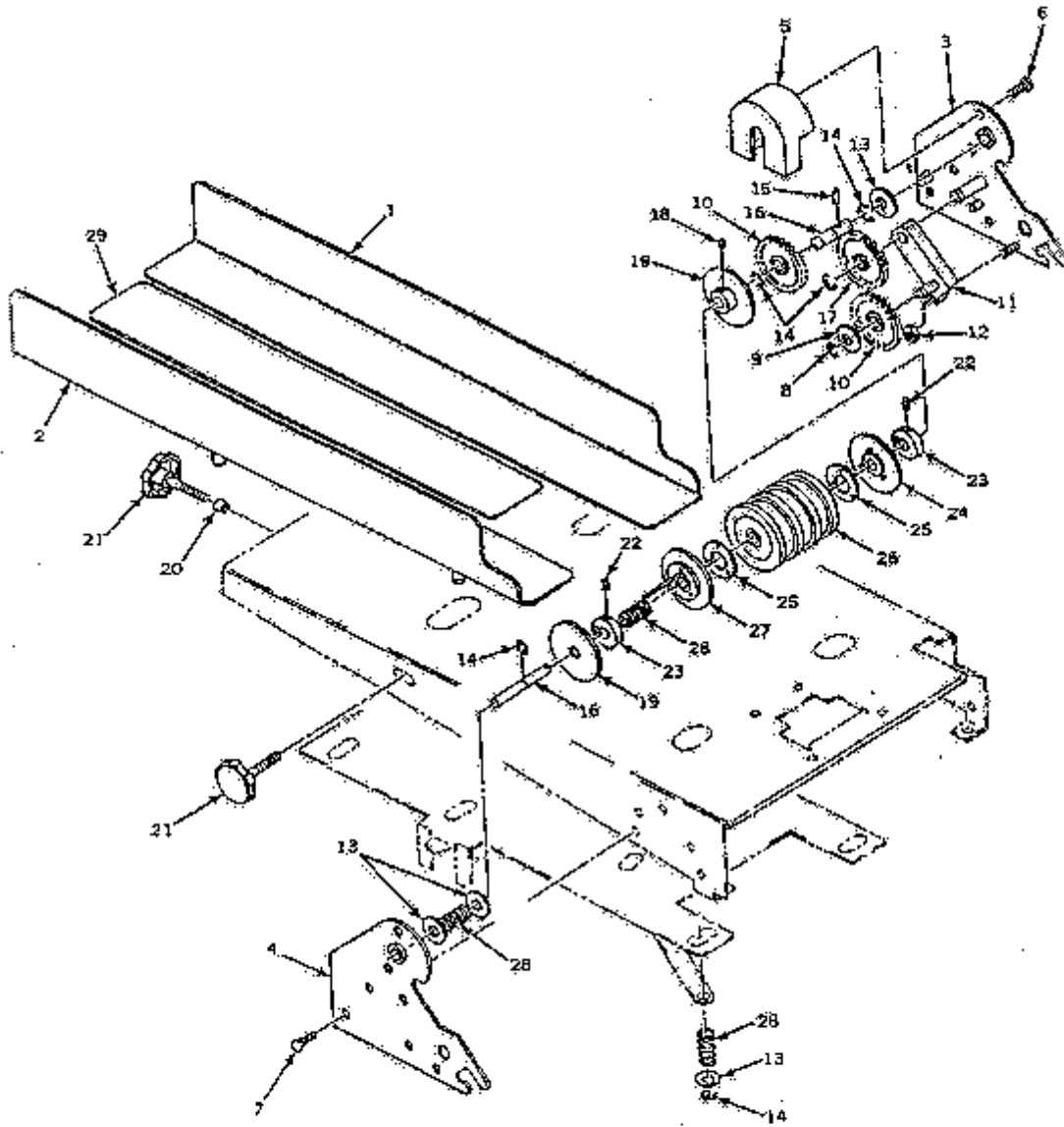

## PARTS LISTING

### FIG. 10 – F312 SHEET FEEDER

<u>ITEM</u>	<u>PART #</u>	<u>DESCRIPTION</u>	<u>QTY</u>
1	F380038	SIDE GUIDE ASSEMBLY - LEFT	1
2	F380037	SIDE GUIDE ASSEMBLY - RIGHT	1
3	F380042	FEEDER HOOK ASSEMBLY - LEFT	1
4	F380041	FEEDER HOOK ASSEMBLY - RIGHT	1
5	F362022	COVER – FEEDER GEAR	1
6	373-0084	8-16 TAPPING SCREW	2
7	373-0016	10-32 X ½” SCREW - PSPN	10
8	379-0026	CLIP – RETAINER – 5/16 - SPINDLE	2
9	377-0043	FLAT WASHER .376 X .876 X .060	2
10	F333002	GEAR – FEED ROLLER	2
11	F380060	GEAR LINK FEEDER ASSEMBLY	1
12	378-0110	NUT – 10-32 X 3/8” - LW	3
13	50-0028	WASHER .437” X 1.000” X .084”	14
14	379-0014	CLIP – RETAINER – 3/8” SPINDLE	8
15	381-0075	SPRING PIN .125 X .625	1
16	F310014	SHAFT – ROLLER FEEDER	1
17	F333003	GEAR - MODIFIED	1
18	376-0107	6-32 X .375 FLAT TIP SCREW SET	2
19	F318004	HUB - FEEDER	2
20	170-0090	BEARING - PLAIN	1
21	F380077	ADJUSTMENT KNOB ASSEMBLY	2
22	376-0006	SCREW SET 10-32 X 3/8” FLAT POINT	2
23	181821	COLLAR – HUB – DRIVE FEED CLUTCH	2
24	F380078	LH HUB – FEED ROLLER CLUTCH	1
25	176706	FRICTION WASHER – FEED ROLLER	2
26	F384004	FEED ROLLER ASSEMBLY	1
27	F380079	FEEDER CLUTCH HUB ASSEMBLY - RIGHT	1
28	F320004	COMPRESSION SPRING - TENSION	7
29	F380036	CONTROL PLATE ASSEMBLY	1
	390-0756	WHOLE SHEET FEED ASSEMBLY	
30	330-5715	COLLAR ¼” I.D.	2
30A	376-5809	10-32 X 3/16 SETSCREW FOR COLLAR	2

Fig. 11- F312 Sheet Feeder Continued

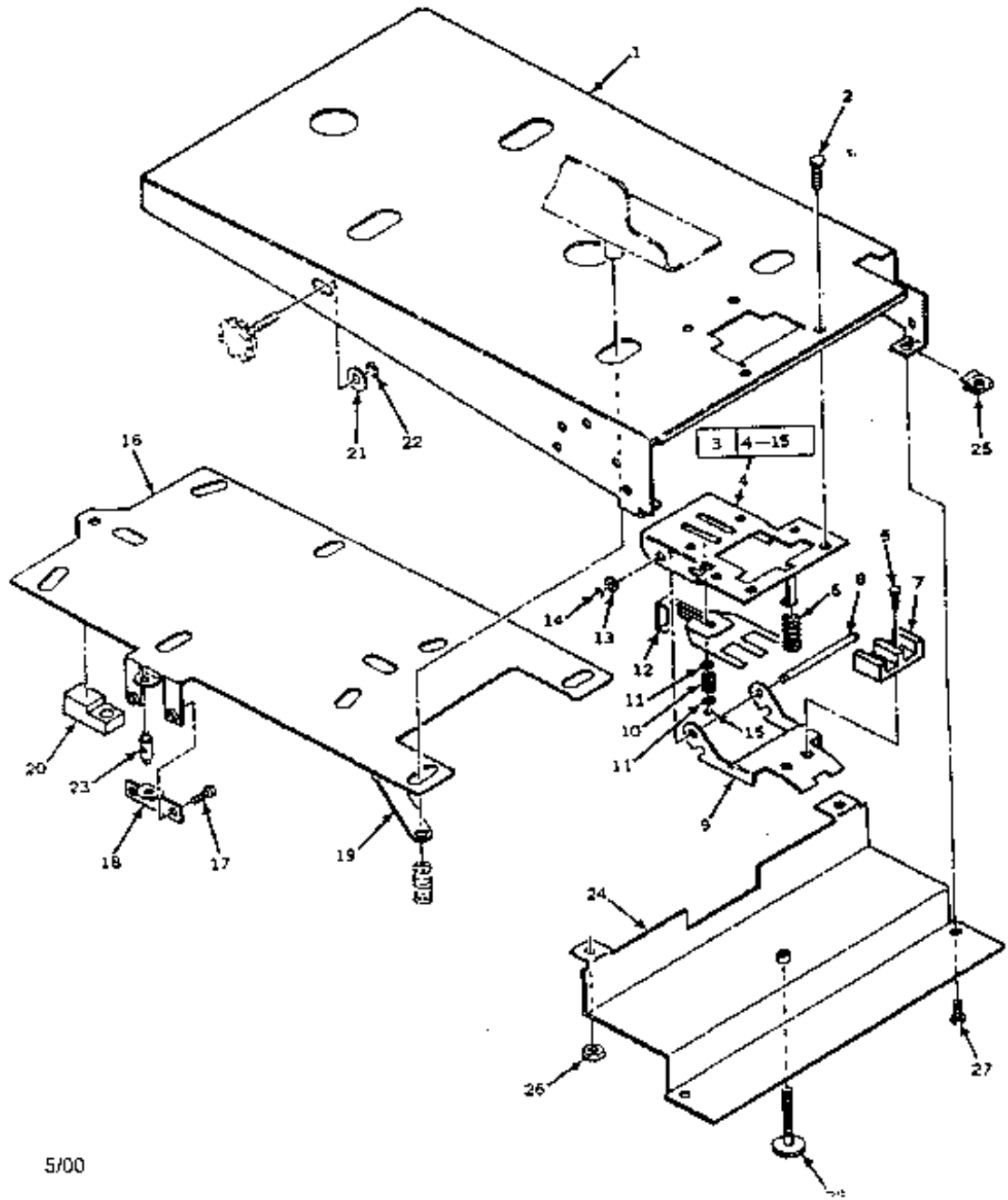

## PARTS LISTING

### FIG. 11-F312 SHEET FEEDER CONTINUED

<u>ITEM</u>	<u>PART #</u>	<u>DESCRIPTION</u>	<u>QTY</u>
1	F380039	FEEDER DECK ASSEMBLY	1
2		SCREW 6-32 X 3/8" – PFN (NOT IN SYSTEM, NEED #	4
3	F380086	MTG. STONE ASSEMBLY	1
4	F380085	STONE BRACKET ASSEMBLY	1
5	373-0079	SCREW W/ LOCK WASHER	2
6	F320004	SPRING COMPRESSION	1
7	3362018	STONE SEPARATOR PP	1
8	F310013	SHAFT – STONE FEEDER	1
9	F380084	FEEDER MOUNTING STONE BRACKET ASSEMBLY	1
10	342-0022	SPRING DATER DOOR - TENSION	2
11	377-2811	#6 PLAIN WASHER	4
12	390-0252	FEEDER ADJUSTMENT BRACKET ASSEMBLY	1
13	377-0013	WASHER PLAIN	2
14	379-0009	CLIP – RETAINER – 3/16" SPINDLE	2
15	379-0020	CLIP – RETAINER – 1/8" SPINDLE	2
16	F380058	FEED PLATE ASSEMBLY	1
17	373-0016	SCREW 10-32 X 1/2" - PSPN	2
18	F351024	BRACKET - FEEDER	1
19	F350004	LINK - FEEDER	4
20	F345000	BLOCK – THREAD ADJUSTING	1
21	377-1813	1/4" WASHER - PLAIN	2
22	379-0008	CLIP – RETAINER – 1/4" SPINDLE	2
23	F312001	PIN – ALIGNMENT THREAD	1
24	F380059	FEEDER BOTTOM COVER ASSEMBLY	1
25		CLIP ** NOT IN SYSTEM, PART # NEEDED	2
26	378-0110	NUT 10-32 X 3/8" - LW	2
27	373-0016	SCREW 10-32 X 1/2" PSPN	2
28	375-0092	1/4 - 20 THUMBSCREW	1
29	330-5715	COLLAR 1/4" I.D.	2
29A	376-5809	10-32 X 3/16" SETSCREW FOR COLLAR	2